

Flange SPREADER™

(Manual)



ST-301



ST-302



ST-303

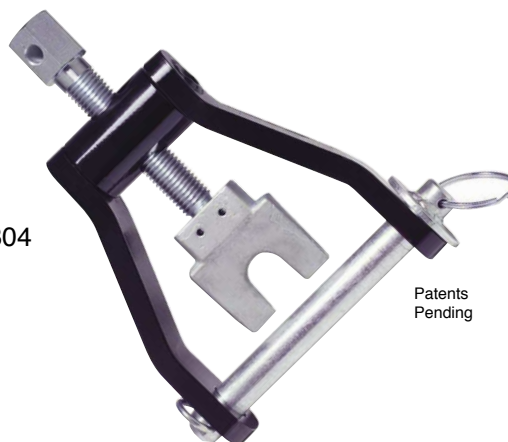

ST-304

Patents Pending

- ✓ 4 models to cover flange range from 1" (25 mm) to 24" (600 mm)
- ✓ Can be used for 150 lb. to 1,500 lb. flanges
- ✓ Hardened wedge for safe splitting
- ✓ Large feed screw
- ✓ Drive can be rotated by 1-3/8" wrench or 1/2" (12 mm) bar
- ✓ Compact design – strong enough for tough jobs

| Part No. | Description | Spread | Pin Diameter | 150 lb | 300 lb | 400 lb | 600 lb | 900 lb | 1,500 lb |
|----------|------------------------|-----------------|--------------|----------|-----------|-----------|---------|--------|----------|
| 784003 | ST-301 Flange Spreader | 3" (76 mm) | 5/8" (16 mm) | 1 - 6" | 0.75 - 4" | 0.5 - 2" | — | — | — |
| 784002 | ST-302 Flange Spreader | 4" (101 mm) | 3/4" (19 mm) | 2 - 12" | 1.5 - 8" | 1 - 4" | 1 - 4" | 1 - 2" | 1 - 2" |
| 784001 | ST-303 Flange Spreader | 5" (127 mm) | 7/8" (22 mm) | 5 - 24" | 2.5 - 12" | 1.5 - 8" | 2 - 6" | 1 - 4" | 1 - 3" |
| 784000 | ST-304 Flange Spreader | 6-3/8" (162 mm) | 1" (25 mm) | 10 - 24" | 7 - 24" | 3.5 - 16" | 4 - 10" | 1 - 8" | 1 - 5" |

Welding Gage

New!



Accurate quick check of internal hi-lo



Root weld spacing with little effort

- ✓ Available in both imperial and metric
- ✓ Measure internal hi-lo misalignment and root weld spacing

| Part No. | Description | Weight | |
|----------|-----------------------|---------|---------|
| 781900 | Welding Gage—Imperial | 0.25 lb | 0.11 Kg |
| 781901 | Welding Gage—Metric | 0.25 lb | 0.11 Kg |

Flange SPREADER™ (Hydraulic)



- ✓ 10 ton flange splitter to tackle the tough jobs
- ✓ Spreader arms adjust from 2-3/4 to 8-1/2" (70 mm to 215 mm)
- ✓ Spring return, single action cylinder
- ✓ Hardened wedge
- ✓ Simple operation
- ✓ Hand pump and 6' (1.5 m) hose available as accessories

Accessories:
Part No. 777010
Hand hydraulic pump for Flange Spreader with 6' (1.5 m) hose and quick disconnect

| Part No. | Description | Capacity | Cylinder Capacity | Cylinder Stroke | Flange Pin Size | 150 lb | 300 lb | 400 lb | 600 lb | 900 lb | 1,500 lb |
|----------|------------------------|-----------|-------------------|-----------------|------------------------|--------|--------|--------|--------|--------|----------|
| 784004 | ST-310 Flange Spreader | 9 x 92 mm | 10 ton | 2" 54 mm | 1.25–1.63" 32–42 mm | 22–42" | 16–28" | 14–24" | 12–20" | 8–16" | 4–8" |

Flange Pins

For accurate alignment of pipe flanges (carbon or stainless steel)

- ✓ Quick installing pins work as convenient reference points to level flange for tack and weld-out —no tools needed
- ✓ Hardened tapered ST-106 and ST-206 pins automatically center on 5/8" to 1-5/8" (16 to 42 mm) holes, ST-258 pins similarly set in 1-1/2 to 2-5/8" (38 to 66 mm) holes
- ✓ Features acme threads for maximum clamping power and hardened steel for long lasting use



| Part No. | Description | Weight |
|----------|------------------------------------|---------------|
| 780430 | ST-106 Flange Pins | 4 Lb 1.8 Kg |
| 780429 | ST-206 Stainless Steel Flange Pins | 4 Lb 1.8 Kg |
| 780650 | ST-258 Flange Pins | 32 Lb 14.5 Kg |

MUL-T-SQUARE[®]

Makes problem fit-up easy and simple set-ups a snap!



- ✓ Lightweight, but durable
- ✓ Handles up to 8" flanges and up to 14" fittings
- ✓ Versatile for measuring 45° and 90° angles
- ✓ Blades marked with both imperial and metric units



The Mul-T-Square consists of two 45° blades which slide effortlessly in an industrial-strength plastic handle. Each blade is made of stainless steel for precise alignment. The 10" (26 cm) and 14" (36 cm) arms allow for measurement of tight fit-ups or they can be expanded for up to 30" squaring of 90° fittings. In some instances, the 45° blades are handy by themselves for simple alignment. The blades are loosened or secured by a simple twist of the conveniently located locking knob.



Now get the Mul-T-Square with extended reach! Blades with 10" (26 cm) and 20" (52 cm) arms provide even greater range. Extended blades fit into the standard Mul-T-Square. Available as blades only or as a complete Mul-T-Square assembly.

Longer stainless steel blades now available!

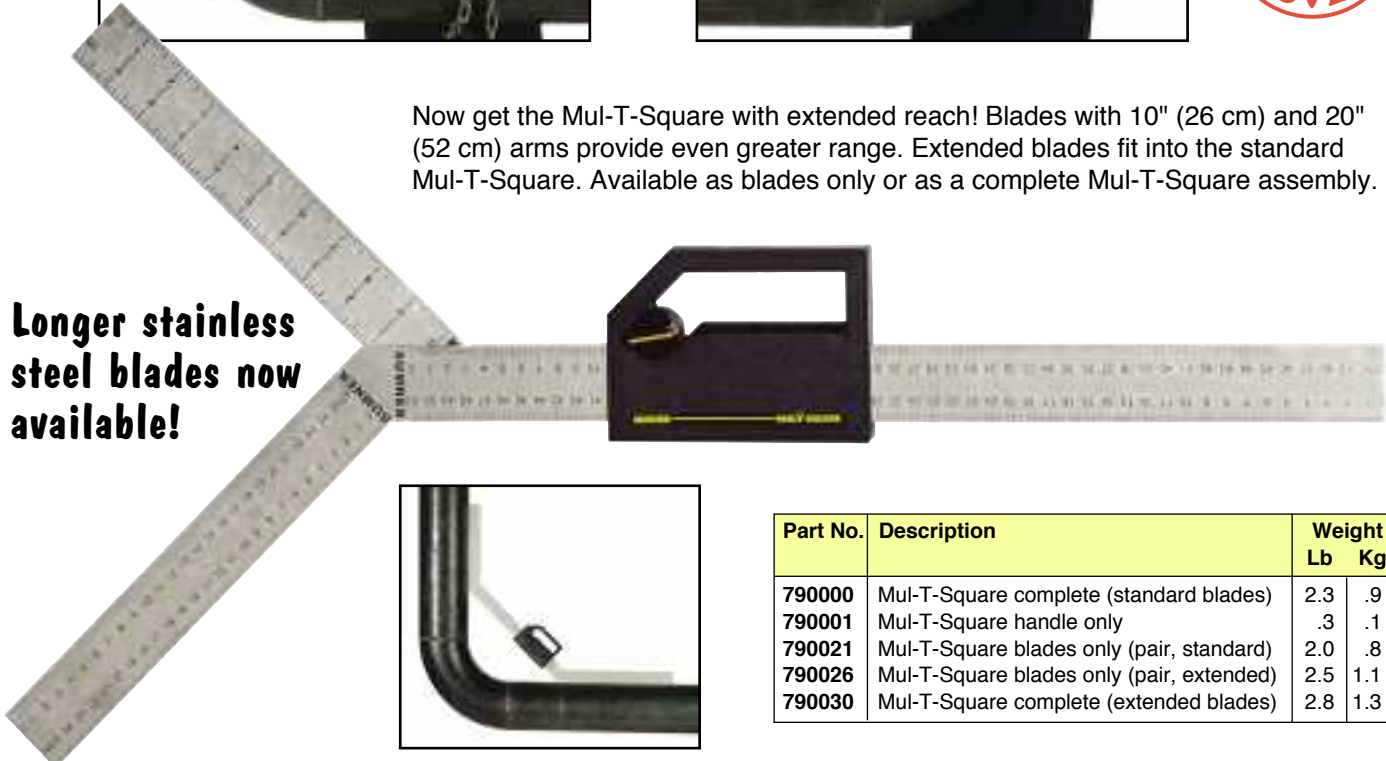

| Part No. | Description | Weight | |
|----------|---|--------|-----|
| | | Lb | Kg |
| 790000 | Mul-T-Square complete (standard blades) | 2.3 | .9 |
| 790001 | Mul-T-Square handle only | .3 | .1 |
| 790021 | Mul-T-Square blades only (pair, standard) | 2.0 | .8 |
| 790026 | Mul-T-Square blades only (pair, extended) | 2.5 | 1.1 |
| 790030 | Mul-T-Square complete (extended blades) | 2.8 | 1.3 |

New!



Multiple Purpose Magnetic Fixtures



Heavy Duty,
Fixed 90°
Fixture

For fast, accurate positioning of flat and round ferrous metal for welding and assembly!

Adjustable-Angle Fixture with scale and repositioning locking handle



Fit-up is a snap with Sumner's line of magnetic welding fixtures...

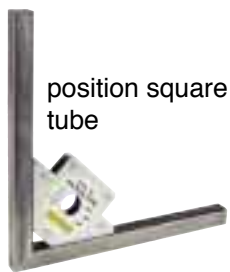

position square tube

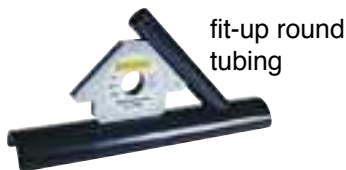

fit-up round tubing



hold tubing to steel plate



fit-up steel plate



use in combination

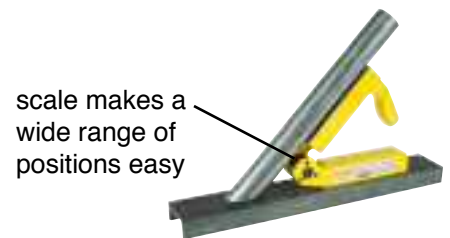

scale makes a wide range of positions easy

| Part No. | Description | Holding Capacity | Dimensions | Angle Configuration | Weight |
|----------|------------------------|--------------------|--|-----------------------------------|------------------|
| 781885 | Multiple Angle Fixture | 28.0 lb (12.5 kg) | 3.75" x 0.5" x 2.5" (96 x 14 x 64 mm) | 30°, 45°, 60° 75°, 90° | 0.6 lb (0.3 kg) |
| 781886 | Small Angle Fixture | 48.5 lb (22.0 kg) | 4.75" x 0.5" x 3.25" (120 x 14 x 82 mm) | 45°, 90°, 135° | 0.6 lb (0.3 kg) |
| 781887 | Medium Angle Fixture | 90.0 lb (41.0 kg) | 6.33" x 0.75" x 4.0" (160 x 20 x 102 mm) | 45°, 90°, 135° | 1.54 lb (0.7 kg) |
| 781888 | Large Angle Fixture | 122.0 lb (55.0 kg) | 7.88" x 0.89" x 5.0" (200 x 22 x 128 mm) | 45°, 90°, 135° | 2.86 lb (1.3 kg) |
| 781875 | Heavy Duty 90° Fixture | 88.0 lb (40.0 kg) | 8.2" x 8.2" x 1.8" (207 x 207 x 48 mm) | 90° | 5.9 lb (2.7 kg) |
| 781876 | Adjustable Fixture | 88.0 lb (40.0 kg) | 8.8" x 8.8" x 1.3" (225 x 225 x 34 mm) | adjustable range from 45° to 270° | 6.4 lb (2.9 kg) |

Pocket Level (PN 781947)



A twin vial level constructed of tough ABS and aluminum frame, the strong magnetic base makes this pocket-size level great for many tasks.

weighs just 3 oz (84 grams)

New!

can be used with a plumb bob



level pipe for fit-up



earth magnet on base and side to hold measuring tape

Versa Level (PN 781945)

Featuring a tough, anodized body and a magnetic base, the Versa Level comes with four vials (0°, 30°, 45°, 90°). There is also a "v" cut into the base for pipe and conduit work.



easy read vials with magnetic base

New!

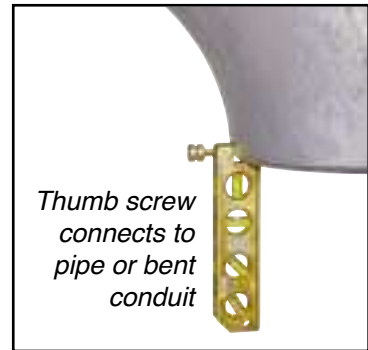

Thumb screw connects to pipe or bent conduit

Quad Level (PN 781946)

This is a tough, anodized aluminum level with a magnetic base and four vials (0°, 30°, 45°, 90°). A "v" cut into the base makes the Quad Level great for pipe and conduit work.



New!



8.5 (21.6 cm) length

Standard Squares

New!

Standard Squares from Sumner are marked with both imperial and metric units.

Steel (PN 781920)

Highly visible lettering and rust-resistant finish

Aluminum (PN 781921)

Lightweight, resists rust

| Part No. | Description | Weight | |
|----------|----------------------------|--------|------|
| | | Lb | Kg |
| 781920 | Standard Square (steel) | 1.36 | 0.62 |
| 781921 | Standard Square (aluminum) | 0.84 | 0.40 |
| 781945 | Versa Level | 0.27 | 0.12 |
| 781946 | Quad Level | 0.38 | 0.17 |
| 781947 | Pocket Level | 0.16 | 0.07 |

New!



Magnetic Holders

(PN 781895)

Sold in packages of three, Sumner Magnetic Holders can be used to position a standard builder's square for layout work or to create an ideal burning guide. Holds squares up to 1/8" (3 mm) thick.

use with a standard square to create a great torch guide



New!

Magnetic Torch Guide Kit (PN 781896)

Kit includes two Sumner Magnetic Holders and a 24" (61 cm) stainless steel cutting rail for straight torch work.



Rotary Ground Clamp (PN 780435)

Puts an end to tangled ground leads

- ✓ Rotary head turns with the pipe—puts an end to ground lead twist, tangle and wear
- ✓ Provides quick, positive ground for roll-out welding of pipe and fittings—eliminates weld pinholes caused by poor grounding
- ✓ Attaches and detaches in seconds
- ✓ Makes up ground leads three ways—lug, clamp-on and bare cable
- ✓ Positive anti-arc bearings take loads up to 400 amps



| Part No. | Description | Weight | |
|----------|-------------------------------|--------|------|
| | | Lb | Kg |
| 780435 | Rotary Ground Clamp | 5.00 | 2.30 |
| 781895 | Magnetic Holders (3 per pkg.) | 1.00 | 0.45 |
| 781896 | Magnetic Torch Guide | 1.95 | 0.88 |

NLV™

(nice little vise)

SUMNER®

TRI-POD PIPE VISE & BENCH VISE



NLV Tri-pod Pipe Vise

Part Number 783207

- ✓ 1/8 to 2-1/2" (3-60 mm) pipe capacity
- ✓ 1/2" pipe bending shoes
- ✓ 1" heavy wall tubing for greater stability
- ✓ Large rubber skid pads bolted to leg
- ✓ Convenient carrying handle
- ✓ Light weight
- ✓ Great price

Bench Chain Vise

Part Number 783200

- ✓ 1/8 to 2-1/2" (3-60 mm) pipe capacity
- ✓ 1/2" pipe bending shoes
- ✓ Cast iron frame
- ✓ Hardened alloy steel jaws

| Part No. | Description | Weight | |
|----------|-----------------------------|--------|------|
| | | Lb | Kg |
| 783207 | NLV Tri-pod with Chain Vise | 29.0 | 13.8 |
| 783200 | Bench Chain Vise | 7.5 | 3.4 |

Fit Stix

The Perfect
Fit-Up Tool
for Steel
Plate!



Align steel plate quickly and easily with Fit Stix!

- ✓ Rugged, lightweight design.
- ✓ Fast, accurate alignments.
- ✓ Drop forged heads.
- ✓ Head can be used for setting gap

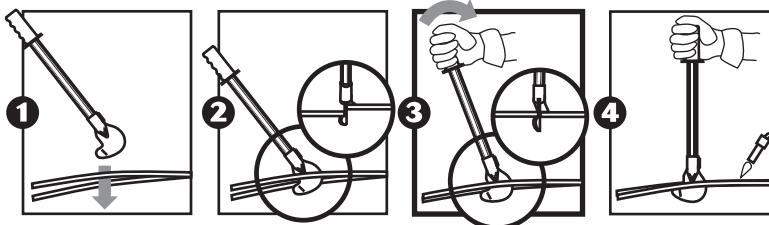

Fit Stix #3

Maximum Range: 1/8" (3 mm)
Gap Setting: 1/16" (1.5 mm)

Fit Stix #8

Maximum Range: 5/16" (8 mm)
Gap Setting: 5/64" (2 mm)

Fit Stix #12

Maximum Range: 1/2" (12 mm)
Gap Setting: 3/16" (5 mm)

| Part No. | Description | Weight | |
|----------|--------------|--------|------|
| | | Lb | Kg |
| 781850 | Fit Stix # 3 | 1.00 | 0.50 |
| 781860 | Fit Stix #8 | 1.43 | 0.65 |
| 781870 | Fit Stix #12 | 1.87 | 0.85 |

HANDi-BENCH

a portable welding table



Use occasionally or as a permanent work bench

- ✓ Tough #9 expanded metal top
- ✓ 600 lb (270 Kg) load capacity
- ✓ 1" square tube frame
- ✓ One piece construction
- ✓ 24 X 40" (60 X 100 cm) work surface
- ✓ Table top plated for ground clamp



Built-in torch holder



Four point leg contact.



The optional 8" wheel kit for the Handy-Bench allows for rolling transport of table in folded position only.



Plunger pin locks legs in open or folded position.



Compact storage

| Part No. | Description | Work Dimension | | | Load Capacity | Weight | |
|----------|---|-----------------|---------------|------------------|-----------------|--------|------|
| | | Height | Depth | Length | | Lb | Kg |
| 783980 | HB-604 Welding Table | 36.3" (92.2 cm) | 24.4" (62 cm) | 40.4" (102.6 cm) | 600 lb (270 Kg) | 54.0 | 24.5 |
| 783965 | 8" Wheel Kit for Series 600 Handi-Bench | | | | | 5.0 | 2.3 |